

WUSM Current and Future Major Projects

Updated: 2/2/2015

East McDonnell & CSRB-NTA Specialized Research Facilities Division of Comparative Medicine, Rack Washer Replacement

Rack washer replacement in East McDonnell & CSRB-NTA Specialized Research Facilities.

WUSM Project Manager: Katie Aholt

Architect: KJWW

Engineer: KJWW

Contractor: Volk

Start Date: August 2013

Completion Date: February 2015

Status: East McDonnell facility is fully operational. CSRB-NTA equipment has been released for fabrication with construction and replacement work scheduled for January, 2015.

4511 Forest Park Parkway Infrastructure and Roof Replacement Project

Major infrastructure upgrades to replace building air handlers, chillers and to construct a chiller room. Consolidate the cooling systems into a single water-cooled chiller plant and replace worn out rooftop air handling units. The roof will also be replaced during the project.

WUSM Project Manager: Nick Dochwat

Engineer: 8760

Contractor: Haberberger

Phase I Chiller Room: Complete

Phase II Chiller & Cooling Tower AHU Replacement:

Start Date: 5/1/14

Completion Date: 5/15/15

Status: In progress

Storz Relocation To TAB Parking Lot

Design-build construction of a 2-story, **25,000** BGSF on the south side of the TAB Building to accommodate relocation of the Storz occupants.

WUSM Project Managers: Ron Olech/Roger Gain

Architect: The Lawrence Group

Contractor: Interface Construction

Start Date: July 3, 2014

Completion Date: May 2015

Status: Site work underway.

Scott McKinley Research Building

The construction of a new research building on the WUMC campus to accommodate the decision to consolidate the Department of Genetics. Space in the new building will also accommodate new recruitments for the Center for Genomic Science, the Department of Medicine, Regenerative Medicine and a Cellular Imaging Core. The fit-out of 2/3 of the 2nd floor shell space for Radiology has been added to the project scope.

WUSM Project Manager: Katie Aholt

Architect: Goody Clancy/Christner

Engineer: KJWW

Contractor: Clayco

Start Date: June 17, 2013

Construction Completion Date: June 30, 2015

Status: Construction work is progressing. Installation of the exterior stone panels and glass is ongoing. MEP installation and interior framing/drywall are ongoing. Construction completion targeted for June 30, 2015 with owner occupancy and move-in July-August.

BJC Institute of Health

Fit-out of 9,000 bgsf of shell space on the 9th floor for HPAN/CIMED expansion.

WUSM Project Manager: Paul Duell

Architect: Cannon **Engineer:** R&B

Contractor: Interface

Start Date: Oct. 3, 2014 **Completion:** Apr 2015

Status: Under Construction

Coal Bunker Headquarters (CBHQ)

Construction of an administrative office building for joint use by BJC/WUSM.

WUSM Project Manager: Steve Sobo

Architect: Christner **Engineer:** KJWW

Contractor: TBD

Start Date: July 2015 **Completion Date:** January 2017

Status: Working on SDs with Design Assist team to be complete by 2/19/15. Finalizing demo/remediation bid documents.

New Environmental Health & Safety Building

Construction of a new 1.5 story building on the McKinley site for the Environmental Health & Safety Processing and Storage functions. Central Services Shipping and Receiving will be located on the Upper Level. Elevators and tunnel connection to SMRB will be located on the Lower Level.

WUSM Project Manager: Paul Mayer

Architect: HKW

Engineer: SSC

Contractor: Clayco

Start Date: May 2014

Construction Completion Dates:

Phase 1-Central Services May 8, 2015

Phase 2 - EH&S May 29, 2015

Occupancy Dates:

Phase 1-Central Services May 18, 2015

Phase 2 - EH&S June 29, 2015

Status: Construction work is 45% complete. Steel installation is 95% complete.



New Shriners Hospital

Solely funded and managed by Shriners.

Scope is potentially an out-patient facility with an estimate of 60,000 s.f.

WUSM Project Manager: NA

Architect: Christner **Engineer:** Ross & Baruzzini

Contractor: S.M. Wilson

Start Date: 4/1/13

Completion Date: December, 2014

Status: Under construction. First patients in April, 2015 delayed due to water damage.

UPDATED INFORMATION IN RED

WUSM Current and Future Major Projects

Updated: 2/2/2015

Siteman Cancer Center – Medical Oncology Expansion

1,620 sf expansion to the Infusion Area and 2,760 sf expansion of the Exam and Support area, including increased parking for patients and staff.

WUSM Project Manager: John Brauer

Architect: BSA **Engineer:** Ross + Baruzzini

Contractor: Paric

Start Date: March 2015 **Completion Date:** September 2015

Status: Issuing Construction documents to proceed with construction. Project phased to coincide with Phase 2 building.

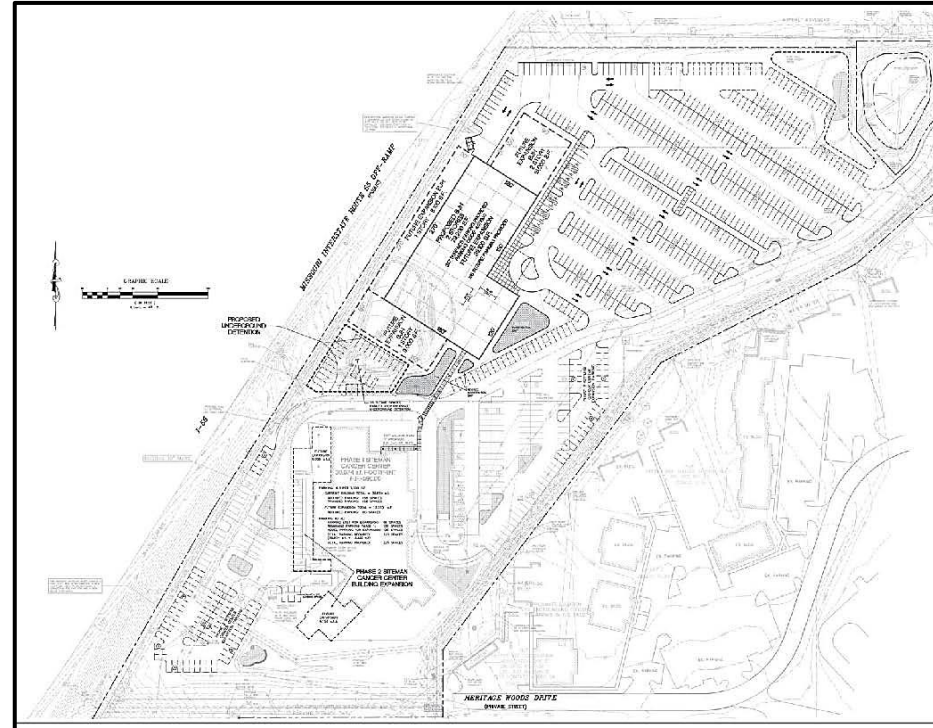

South County Phase 2

New, two-story, 84,500 sf Medical Office Building located just north of Siteman Cancer Center South County (Phase 1). Building will offer out-patient and same day surgery medical services.

WUSM Project Manager: John Brauer

Architect: BSA **Engineer:** Ross + Baruzzini

Contractor: Paric

Start Date: February 2015 **Completion Date:** February 2016

Status: Issuing Construction documents to proceed with construction.

OPAC (Off-site Pediatric Ambulatory Center)

New, three-story, 140,999 sf Medical Office Building located at Hwy 64/40 + Mason Road. Building will provide pediatric out-patient services.

WUSM Project Manager: John Brauer

Architect: Cannon Design **Engineer:** Cannon Design

Contractor: Paric

Start Date: May 1, 2014 **Completion Date:** May 15, 2015

Status: Completing site work as weather permits. Proceeding with installation of final finishes and casework.

