

WUSM Current and Future Major Projects

Updated: 4/21/2015

East McDonnell & CSRB-NTA Specialized Research Facilities Division of Comparative Medicine, Rack Washer Replacement

Rack washer replacement in East McDonnell & CSRB-NTA Specialized Research Facilities.

WUSM Project Manager: Katie Aholt

Architect: KJWW

Engineer: KJWW

Contractor: Volk

Start Date: August 2014

Completion Date: April, 2015

Status: Equipment replacement complete and operation in East McDonnell. Construction work and final equipment installation is nearing completion in CSRB-NTA. Equipment start up and site acceptance testing to be completed by the end of April 2015.

4511 Forest Park Parkway Infrastructure and Roof Replacement Project

Major infrastructure upgrades to replace building air handlers, chillers and to construct a chiller room. Consolidate the cooling systems into a single water-cooled chiller plant and replace worn out rooftop air handling units. The roof will also be replaced during the project.

WUSM Project Manager: Nick Dochwat

Engineer: 8760

Contractor: Haberberger

Phase I Chiller Room: Complete

Phase II Chiller & Cooling Tower AHU Replacement:

Start Date: 5/1/14

Completion Date: 6/30/2015

Phase III

Start Date: 6/30/2015

Completion Date: 10/15/2015

Status: Scheduled to re-start construction on May 11th.

Storz Relocation To TAB Parking Lot

Design-build construction of a 2-story, 25,000 BGSF on the south side of the TAB Building to accommodate relocation of the Storz occupants.

WUSM Project Managers: Ron Olech/Roger Gain

Architect: The Lawrence Group

Contractor: Interface Construction

Start Date: July 3, 2014

Substantial Completion Date: June 1, 2015

Status: Structural framing is complete. Sheathing and masonry work underway. Roofing is installed. The MEP Rough-In is continuing on the 1st and 2nd floors. Sewer work under Taylor is complete. 80% of the interior stud work is complete. We are still working 10 hour days and Saturdays for issues on the critical path to try and beat the June 1, 2015 Substantial Completion Date.

4515 McKinley Research Building

The construction of a new research building on the WUMC campus to accommodate the decision to consolidate the Department of Genetics. Space in the new building will also accommodate new recruitments for the Center for Genomic Science, the Department of Medicine, Regenerative Medicine and a Cellular Imaging Core. The fit-out of 2/3 of the 2nd floor shell space for Radiology has been added to the project scope.

WUSM Project Manager: Katie Aholt

Architect: Goody Clancy/Christner

Engineer: KJWW

Contractor: Clayco

Start Date: June 17, 2013

Construction Completion Date: July, 28 2015

Status: Construction work is progressing. Exterior Glass Installation in progress along north elevation. MEP installation is ongoing. Drywall work is nearing completion with taping taking place on upper floors. Painting and ceiling grid is taking place in the basement. Owner occupancy and move-in will take place August 2015.

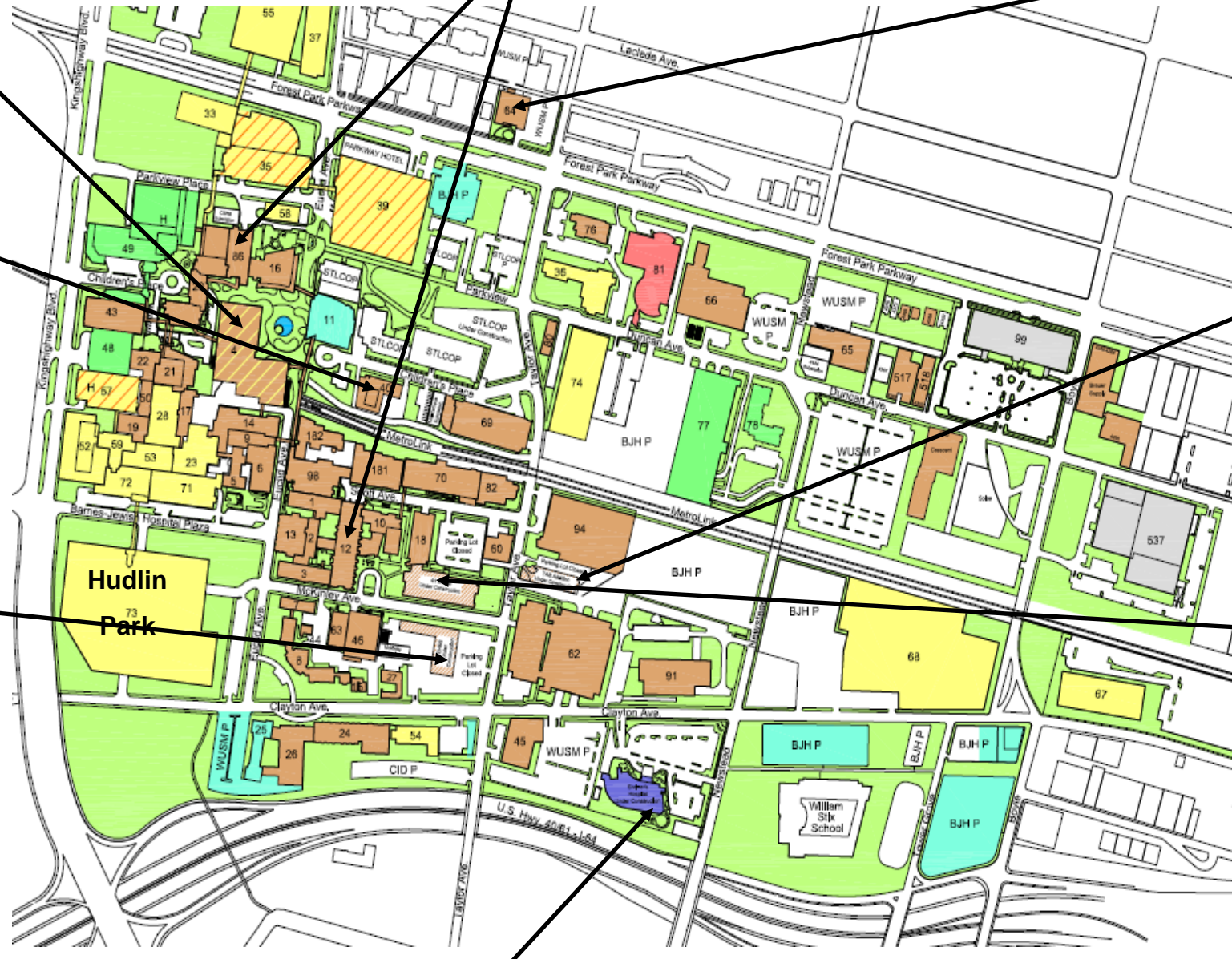

BJC Institute of Health

Fit-out of 9,000 bgsf of shell space on the 9th floor for HPAN/CIMED expansion.

WUSM Project Manager: Paul Duell

Architect: Cannon

Engineer: R&B

Contractor: Interface

Start Date: Oct. 3, 2014

Substantial Completion Date: April, 15 2015

Status: Under Construction

Mid Campus Center (MCC)

Construction of an administrative office building for joint use by BJC/WUSM.

WUSM Project Manager: Steve Sobo

Architect: Christner

Engineer: KJWW

Contractor: Clayco

Start Date: July 2015

Substantial Completion Date: December 2016

Status: Christner continues with the Design Development phase. Working with Clayco on Design-Assist bid packages. WUSM and BJC detailed programming nearly complete.

New Environmental Health & Safety Building

Construction of a new 1.5 story building on the McKinley site for the Environmental Health & Safety Processing and Storage functions. Central Services Shipping and Receiving will be located on the Upper Level. Elevators and tunnel connection to SMRB will be located on the Lower Level.

WUSM Project Manager: Paul Mayer

Architect: HKW

Engineer: SSC

Contractor: Clayco

Start Date: May 2014

Construction Completion Dates:

Phase 1-Central Services May 8, 2015

Phase 2 – EH&S May 29, 2015

Occupancy Dates:

Phase 1- WUSM Mail Room & Receiving May 15, 2015

BJC Mail Room & Receiving May 29, 2015

Phase 2 – EH&S June 20, 2015

Status: Project is under construction and is approximately 75% complete.

New Shriners' Hospital

Solely funded and managed by Shriners.

Scope is potentially an out-patient facility with an estimate of 60,000 s.f.

WUSM Project Manager: NA

Architect: Christner

Engineer: Ross & Baruzzini

Contractor: S.M. Wilson

Start Date: 4/1/13

Completion Date: December, 2014

Status: Under construction. First patients in June, 2015 .

UPDATED INFORMATION IN RED

WUSM Current and Future Major Projects

Updated: 4/21/2015

Siteman Cancer Center – Medical Oncology Expansion

1,620 sf expansion to the Infusion Area and 2,760 sf expansion of the Exam and Support area, including increased parking for patients and staff.

WUSM Project Manager: John Brauer

Architect: BSA **Engineer:** Ross + Baruzzini

Contractor: Paric

Start Date: April 2015 **Completion Date:** September 2015

Status: Paric mobilized on site. Start of earthwork scheduled for early April.

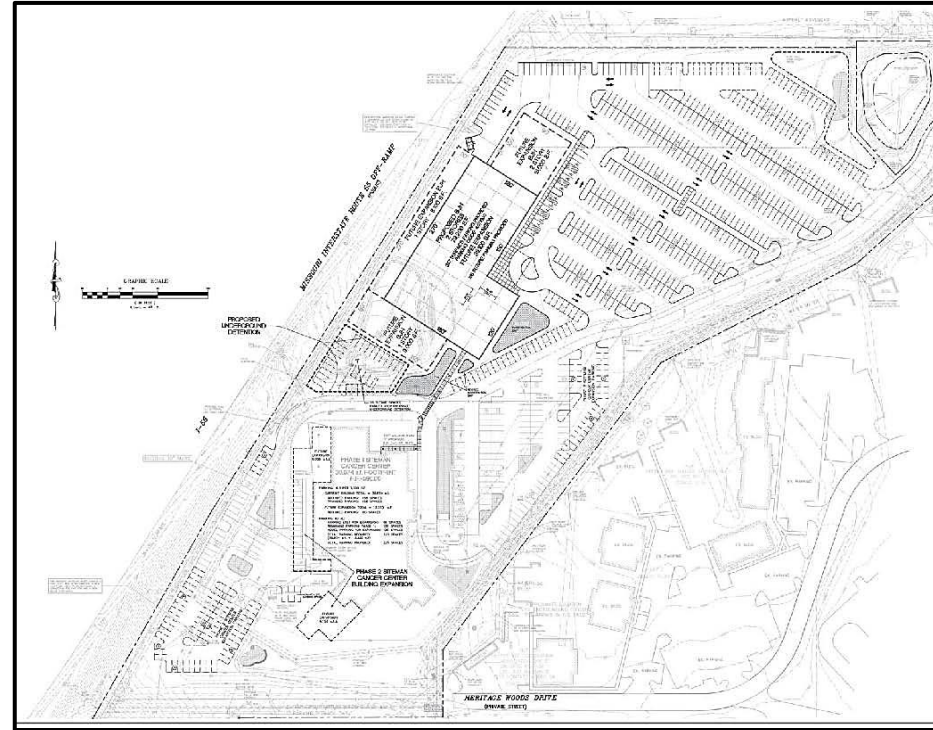

South County Phase 2

New, two-story, 84,500 sf Medical Office Building located just north of Siteman Cancer Center South County (Phase 1). Building will offer out-patient and same day surgery medical services.

WUSM Project Manager: John Brauer

Architect: BSA **Engineer:** Ross + Baruzzini

Contractor: Paric

Start Date: March 9, 2015 **Completion Date:** March 28, 2016

Status: Continuing with earthwork. Anticipate completion of building pad area in June, weather permitting. Anticipate start of footings and foundations week of 4/13/15.

OPAC (Off-site Pediatric Ambulatory Center)

New, three-story, 140,999 sf Medical Office Building located at Hwy 64/40 + Mason Road. Building will provide pediatric out-patient services.

WUSM Project Manager: John Brauer

Architect: Cannon Design **Engineer:** Cannon Design

Contractor: Paric

Start Date: May 1, 2014 **Completion Date:** May 1, 2015

Status: Completing remaining site paving as weather permits and completion of canopy skin. Site landscaping in process of completion. Punched 2nd floor suites 4/2 and 4/3. 1st floor punch scheduled for week of 4/13. 2nd Floor common area punch scheduled for 4/9. Anticipated project substantial completion 5/1/15. Departmental moves scheduled for 5/29 and 5/30 with opening for patients 6/2/15.

