

FACILITIES OPERATIONS UPDATE (Week of July 19th to July 25th, 2015)

(Important WUSM coordinative communication. Please share by email.)

To: Key Stakeholders
CC: Facilities Management

This week's topics include:

- 4515 McKinley Research/EHS Central Services Tunnel Now Open
- Limited Vehicles/Foot Traffic Due to Crane Behind Euclid Power Plant

4515 McKinley Research/EHS Central Services Tunnel Now Open

From: Peggy Smith, Manager of Central Mail Services

The tunnel connecting 4515 McKinley Research Building and the EHS Central Services Building is now open to all internal staff as of Monday, July 20th. You will need your ID badge to access the tunnel. You may access the tunnel from the first floor elevator in the McDonnell Sciences Building and press "B" for basement.

Once you get off the elevator, please look for the Central Services Mail/Receiving sign and follow the directions. See the map below.

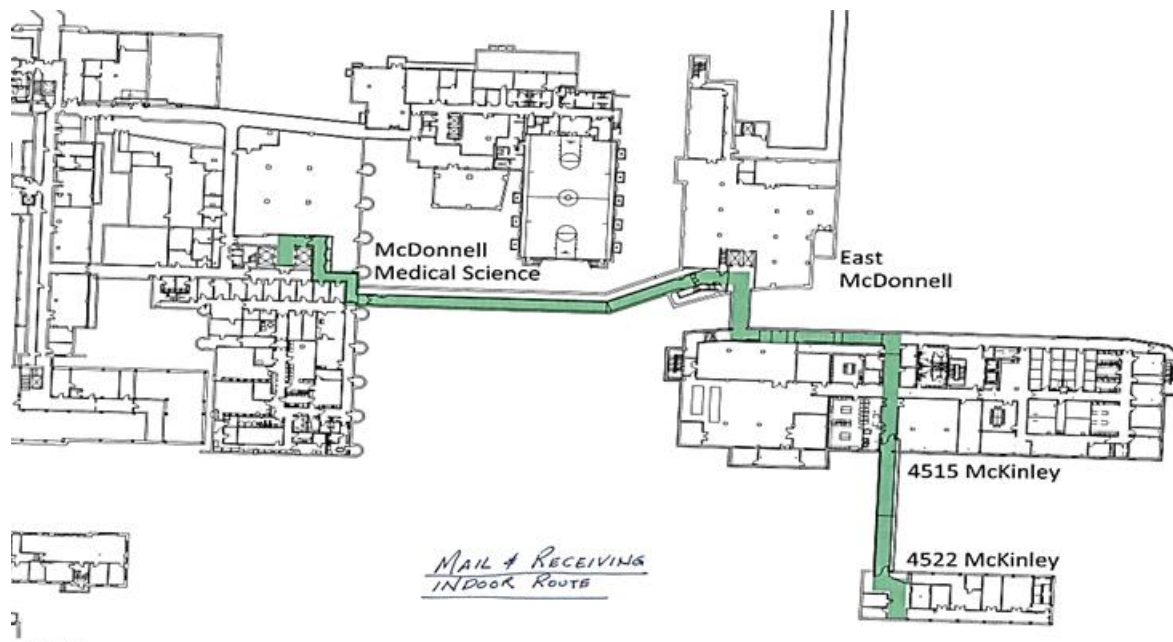

Limited Vehicles/Foot Traffic Due to Crane Behind Euclid Power Plant

From: Paul Schermesser, Supervisor in Facilities Engineering

Tomorrow (July 22nd), there will be a crane behind the Euclid Power Plant (south side between FLTC and the Power Plant). There is work that needs to be done on the roof of the power plant between the hours of 7am – 4pm. Security will tape off the area tonight and there will not be any foot traffic or vehicles allowed in that area.

Michelle Gubin
Communication & Facilities Administration Manager
Phone: 314-362-0214
Email: gubinm@wusm.wustl.edu



Our Core Values: **PRIDE** in Service, Do the Right Thing
Professionalism **R**espect **I**ntegrity **D**edication **E**xcellence