

**NEWSTEAD AVE STREET IMPROVEMENTS  
PHASE 8 TRAFFIC CONTROL PLAN**  
 Work to take place from 7:00AM to 4:30PM daily  
 Work dates: 8/10/2020 to 9/4/20  
 2 lanes of traffic to be maintained for east and westbound Forest Park Ave.  
 Two way traffic to be maintained on Newstead Ave.

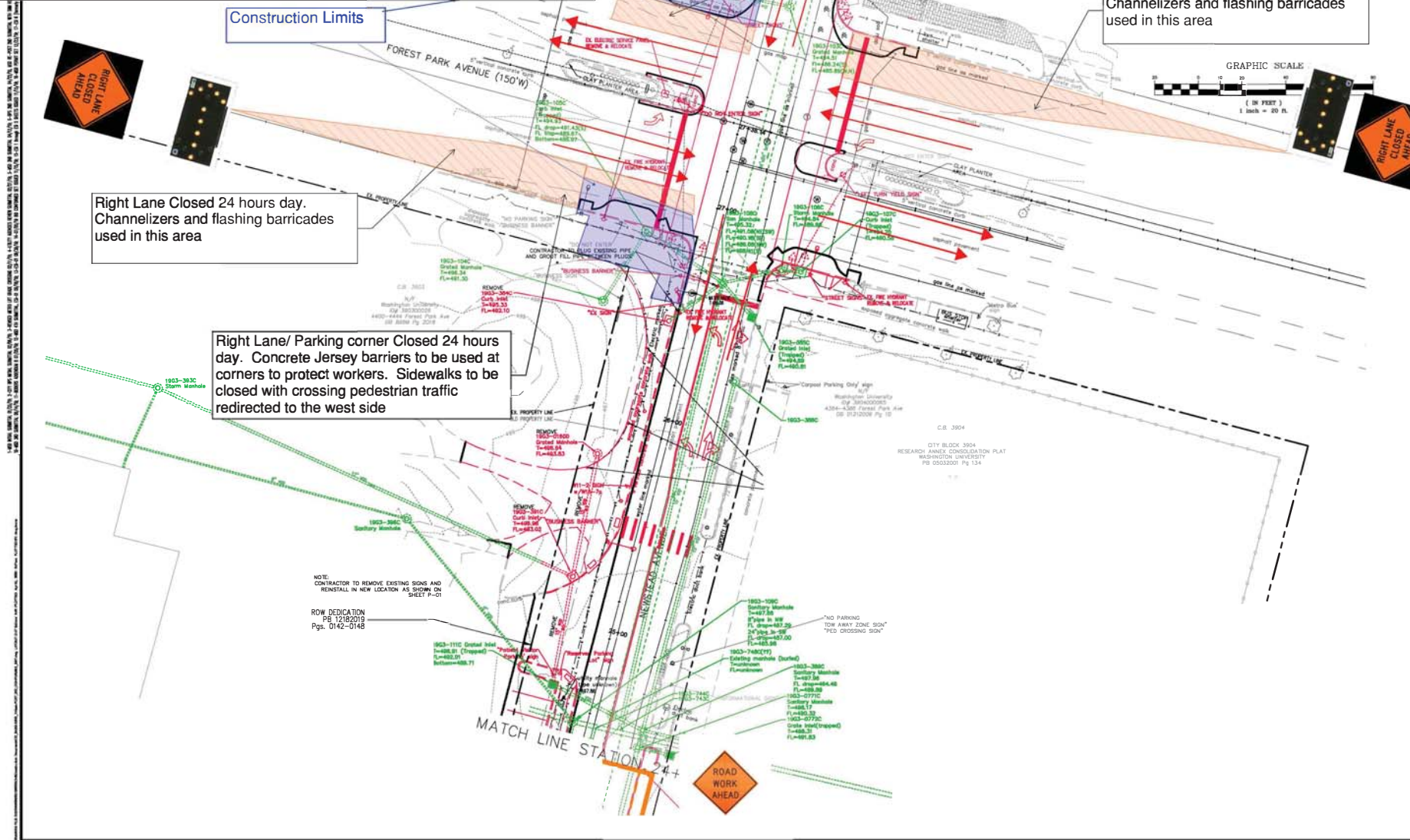

Right Lane/Parking corner Closed 24 hours day. Concrete Jersey barriers to be used at corners to protect workers. Sidewalks to be closed with crossing pedestrian traffic redirected to the west side

Right Lane Closed 24 hours day. Channelizers and flashing barricades used in this area

Right Lane Closed 24 hours day. Channelizers and flashing barricades used in this area

Right Lane/ Parking corner Closed 24 hours day. Concrete Jersey barriers to be used at corners to protect workers. Sidewalks to be closed with crossing pedestrian traffic redirected to the west side

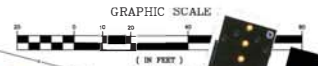

NOTE:  
 CONTRACTOR TO REMOVE EXISTING SIGNS AND REINSTALL IN NEW LOCATION AS SHOWN ON SHEET P-01

ROW DEDICATION  
 PG. 12/2/2019  
 PGS. 0142-0148

250 Cherokee Blaine Parkway  
 Suite 100  
 St. Louis, MO 63104  
 Phone: (314) 433-8800  
 Fax: (314) 433-8801  
 E-mail: g.mstock@stockandstock.com  
 Web: www.stockandstock.com

**STOCK & STOCK**  
 Consulting Engineers, Inc.

ROADWAY IMPROVEMENT PLANS

**NEWSTEAD AVENUE STREET IMPROVEMENTS**

WASHINGTON UNIVERSITY SCHOOL OF MEDICINE  
 SAINT LOUIS  
 MISSOURI

DATE: 04/02/20

STATE OF MISSOURI  
 GEORGE M. STOCK  
 MEMBER  
 PG-2316

REVISIONS:

1	ADD SIGNAGE TO RIGHT LANE
2	REVISE SIGNAGE TO 18" X 24" SIZE
3	ADD SIGNAGE TO RIGHT LANE
4	REVISE SIGNAGE TO 18" X 24" SIZE
5	ADD SIGNAGE TO RIGHT LANE
6	REVISE SIGNAGE TO 18" X 24" SIZE
7	ADD SIGNAGE TO RIGHT LANE
8	REVISE SIGNAGE TO 18" X 24" SIZE

DATE	BY	CHKD BY	APP'D BY
01/25/19			
08/02/20			

SHEET TITLE:  
**EXISTING CONDITIONS PLAN  
 SHEET 5 OF 5**

SHEET NO.:  
**C-07**